



# MALLEABLE IRON FITTINGS

150lb. & 300lb. Malleable Iron Pipe Fitting Product Specifications



- ✘ *Manufacturing Facility is ISO9001:2000*
- ✘ *Fittings Pressure Tested & Straightness Tested*
- ✘ *Dimensions Conform to ASME B16.3*
- ✘ *Material Conforms to ASTM A197*
- ✘ *Threads Conform to ASME B1.20.1*



800-678-2544 ☎ • 800-678-0857 📠 • [www.msi-products.com](http://www.msi-products.com)

© Copyright 2009

**MSI Malleable Iron Pipe Fitting Specifications**

800-678-2544 phone 800-678-0857 fax www.msi-products.com msisales@msi-products.com

THREADS: ANSI / ASME B1.20.1 DIMENSIONS: ANSI B16.3 MATERIAL: ASTM A197

**90° Elbows**

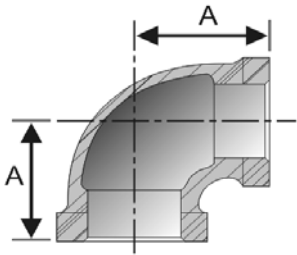

Size	Inner Carton	Master Case	"A" Inch	Black Item Number	Galv. Item Number	Approx. Wgt. Ea / lbs.
1/8"	50	600	0.71	A2010002	A2210002	0.065
1/4"	35	420	0.83	A2010004	A2210004	0.115
3/8"	45	540	0.98	A2010006	A2210006	0.175
1/2"	50	400	1.10	A2010008	A2210008	0.255
3/4"	35	210	1.30	A2010012	A2210012	0.390
1"	20	120	1.50	A2010016	A2210016	0.651
1 1/4"	20	80	1.77	A2010020	A2210020	1.031
1 1/2"	10	60	1.97	A2010024	A2210024	1.342
2"	8	32	2.28	A2010032	A2210032	2.112
2 1/2"	6	18	2.71	A2010040	A2210040	3.841
3"	7	14	3.07	A2010048	A2210048	5.365
4"	2	6	3.78	A2010064	A2210064	9.989

**45° Elbows**

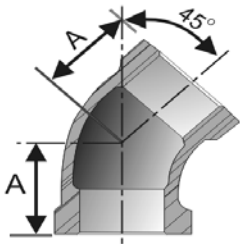

Size	Inner Carton	Master Case	"A" Inch	Black Item Number	Galv. Item Number	Approx. Wgt. Ea / lbs.
1/8"	50	600	0.63	A2010402	A2210402	0.075
1/4"	30	360	0.75	A2010404	A2210404	0.115
3/8"	50	600	0.39	A2010406	A2210406	0.155
1/2"	50	400	0.59	A2010408	A2210408	0.225
3/4"	40	240	0.98	A2010412	A2210412	0.351
1"	20	120	1.10	A2010416	A2210416	0.582
1 1/4"	20	80	1.30	A2010420	A2210420	0.865
1 1/2"	10	60	1.42	A2010424	A2210424	1.155
2"	12	36	1.69	A2010432	A2210432	1.795
2 1/2"	9	27	1.97	A2010440	A2210440	3.021
3"	10	20	2.16	A2010448	A2210448	4.692
4"	2	6	2.59	A2010464	A2210464	8.255

**90° Street Elbows**

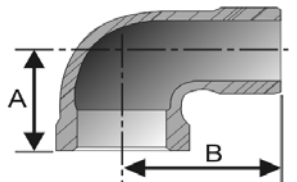

Size	Inner Carton	Master Case	"A" Inch	"B" Inch	Black Item Number	Galv. Item Number	Approx. Wgt. Ea / lbs.
1/8"	60	720	0.71	0.98	A2010602	A2210602	0.065
1/4"	35	420	0.83	1.14	A2010604	A2210604	0.105
3/8"	40	480	0.98	1.46	A2010606	A2210606	0.175
1/2"	60	360	1.10	1.61	A2010608	A2210608	0.255
3/4"	35	210	1.30	1.89	A2010612	A2210612	0.415
1"	30	120	1.50	2.08	A2010616	A2210616	0.665
1 1/4"	25	75	1.77	2.40	A2010620	A2210620	1.102
1 1/2"	9	54	1.97	2.63	A2010624	A2210624	1.495
2"	10	30	2.28	3.26	A2010632	A2210632	3.452
2 1/2"	9	18	2.71	3.85	A2010640	A2210640	4.135
3"	7	14	3.07	4.52	A2010648	A2210648	6.615
4"	2	6	3.78	5.70	A2010664	A2210664	11.551

**MSI Malleable Iron Pipe Fitting Specifications**

800-678-2544 phone 800-678-0857 fax www.msi-products.com msisales@msi-products.com

THREADS: ANSI / ASME B1.20.1 DIMENSIONS: ANSI B16.3 MATERIAL: ASTM A197

**45° Street Elbows**

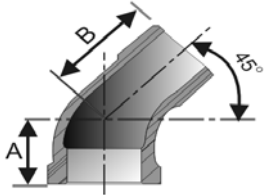

Size	Inner Carton	Master Case	"A" Inch	"B" Inch	Black Item Number	Galv. Item Number	Approx. Wgt. Ea / lbs.
1/8"	70	840	0.63	0.83	A2010802	A2210802	0.065
1/4"	40	480	0.75	0.94	A2010804	A2210804	0.105
3/8"	50	600	0.79	1.02	A2010806	A2210806	0.175
1/2"	75	450	0.87	1.10	A2010808	A2210808	0.255
3/4"	40	240	0.98	1.30	A2010812	A2210812	0.415
1"	25	150	1.10	1.46	A2010816	A2210816	0.665
1 1/4"	10	80	1.30	1.69	A2010820	A2210820	1.102
1 1/2"	10	60	1.42	1.89	A2010824	A2210824	1.495
2"	12	36	1.69	2.20	A2010832	A2210832	3.452
2 1/2"	12	24	1.97	2.56	A2010840	A2210840	4.135
3"	6	18	2.16	2.99	A2010848	A2210848	6.615
4"	1	3	2.59	3.70	A2010864	A2210864	11.551

**Tees**

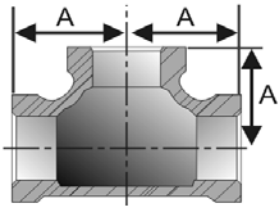

Size	Inner Carton	Master Case	"A" Inch	Black Item Number	Galv. Item Number	Approx. Wgt. Ea / lbs.
1/8"	80	960	0.71	A2020002	A2220002	0.095
1/4"	50	600	0.83	A2020004	A2220004	0.155
3/8"	30	360	0.98	A2020006	A2220006	0.255
1/2"	40	240	1.10	A2020008	A2220008	0.352
3/4"	35	140	1.30	A2020012	A2220012	0.555
1"	20	80	1.50	A2020016	A2220016	0.925
1 1/4"	14	56	1.77	A2020020	A2220020	1.385
1 1/2"	15	45	1.97	A2020024	A2220024	1.835
2"	10	30	2.28	A2020032	A2220032	2.752
2 1/2"	8	16	2.71	A2020040	A2220040	4.995
3"	6	12	3.07	A2020048	A2220048	7.652
4"	2	6	3.78	A2020064	A2220064	14.025

**Side Outlet Elbows**

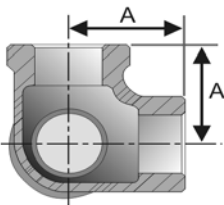

Size	Inner Carton	Master Case	"A" Inch	Black Item Number	Galv. Item Number	Approx. Wgt. Ea / lbs.
1/4"	50	600	0.83	A2010904	A2210904	0.135
3/8"	50	400	0.98	A2010906	A2210906	0.205
1/2"	45	270	1.10	A2010908	A2210908	0.305
3/4"	20	160	1.30	A2010912	A2210912	0.505
1"	20	80	1.50	A2010916	A2210916	0.755
1 1/4"	15	45	1.77	A2010920	A2210920	1.112
1 1/2"	12	36	1.97	A2010924	A2210924	1.495
2"	12	24	2.28	A2010932	A2210932	2.351

MSI Malleable Iron Pipe Fittings Meet the following Specifications: ASME B16.3; ASTM A197; ASME B1.20.1

**MSI Malleable Iron Pipe Fitting Specifications**

800-678-2544 phone 800-678-0857 fax www.msi-products.com msisales@msi-products.com

THREADS: ANSI / ASME B1.20.1 DIMENSIONS: ANSI B16.3 MATERIAL: ASTM A197

**Street / Service Tee**

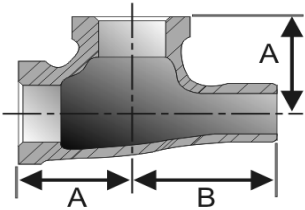

Size	Inner Carton	Master Case	"A" Inch	"B" Inch	Black Item Number	Galv. Item Number	Approx. Wgt. Ea / lbs.
3/8"	40	240	0.94	1.46	A2020406	A2220406	0.255
1/2"	40	240	1.10	1.61	A2020408	A2220408	0.335
3/4"	25	150	1.30	1.89	A2020412	A2220412	0.555
1"	20	80	1.50	2.12	A2020416	A2220416	0.965
1 1/4"	15	60	1.73	2.44	A2020420	A2220420	1.475
1 1/2"	12	36	1.93	2.67	A2020424	A2220424	1.965
2"	8	24	2.24	3.26	A2020432	A2220432	3.335

**Crosses**

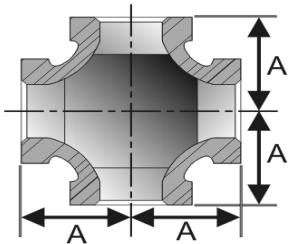

Size	Inner Carton	Master Case	"A" Inch	Black Item Number	Galv. Item Number	Approx. Wgt. Ea / lbs.
1/8"	30	360	0.71	A2030202	A2230202	0.125
1/4"	40	480	0.83	A2030204	A2230204	0.195
3/8"	25	300	0.98	A2030206	A2230206	0.295
1/2"	30	180	1.10	A2030208	A2230208	0.425
3/4"	20	120	1.30	A2030212	A2230212	0.675
1"	15	60	1.50	A2030216	A2230216	1.035
1 1/4"	20	40	1.77	A2030220	A2230220	1.555
1 1/2"	18	36	1.97	A2030224	A2230224	2.075
2"	10	20	2.28	A2030232	A2230232	3.115
2 1/2"	3	12	2.71	A2030240	A2230240	5.655
3"	2	8	3.07	A2030248	A2230248	8.355
4"	2	4	3.78	A2030264	A2230264	13.755

**Unions**

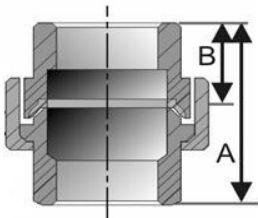

Size	Inner Carton	Master Case	"A" Inch	"B" Inch	Black Item Number	Galv. Item Number	Approx. Wgt. Ea / lbs.
1/8"	30	360	1.26	0.63	A2040802	A2240802	0.194
1/4"	20	240	1.44	0.72	A2040804	A2240804	0.205
3/8"	20	240	1.61	0.81	A2040806	A2240806	0.351
1/2"	50	200	1.72	0.86	A2040808	A2240808	0.432
3/4"	35	140	1.95	0.98	A2040812	A2240812	0.628
1"	20	80	2.06	1.03	A2040816	A2240816	0.912
1 1/4"	15	60	2.26	1.13	A2040820	A2240820	1.354
1 1/2"	10	40	2.40	1.20	A2040824	A2240824	1.755
2"	6	24	2.75	1.38	A2040832	A2240832	2.625
2 1/2"	8	16	3.23	1.61	A2040840	A2240840	4.412
3"	7	14	3.50	1.75	A2040848	A2240848	5.645
4"	1	7	3.86	1.93	A2040864	A2240864	10.345

**MSI Malleable Iron Pipe Fitting Specifications**

800-678-2544 phone 800-678-0857 fax www.msi-products.com msisales@msi-products.com

THREADS: ANSI / ASME B1.20.1 DIMENSIONS: ANSI B16.3 MATERIAL: ASTM A197

**Couplings / Banded**

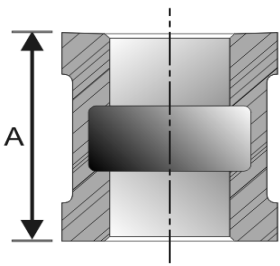

Size	Inner Carton	Master Case	"A" Inch	Black Item Number	Galv. Item Number	Approx. Wgt. Ea / lbs.
1/8"	70	840	0.98	A2030402	A2230402	0.055
1/4"	40	480	1.06	A2030404	A2230404	0.085
3/8"	50	600	1.18	A2030406	A2230406	0.125
1/2"	40	480	1.42	A2030408	A2230408	0.185
3/4"	50	300	1.54	A2030412	A2230412	0.285
1"	25	150	1.77	A2030416	A2230416	0.455
1 1/4"	16	128	1.97	A2030420	A2230420	0.675
1 1/2"	18	72	2.16	A2030424	A2230424	0.925
2"	12	48	2.55	A2030432	A2230432	1.475
2 1/2"	8	32	2.91	A2030440	A2230440	1.525
3"	12	24	3.15	A2030448	A2230448	3.695
4"	6	12	3.70	A2030464	A2230464	6.025

**Caps**

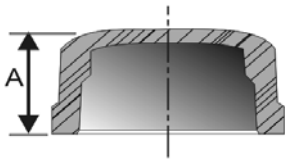

Size	Inner Carton	Master Case	"A" Inch	Black Item Number	Galv. Item Number	Approx. Wgt. Ea / lbs.
1/8"	120	1440	0.55	A2040502	A2240502	0.055
1/4"	80	960	0.63	A2040504	A2240504	0.085
3/8"	60	720	0.75	A2040506	A2240506	0.105
1/2"	75	900	0.91	A2040508	A2240508	0.145
3/4"	40	480	0.98	A2040512	A2240512	0.225
1"	35	280	1.18	A2040516	A2240516	0.345
1 1/4"	25	200	1.30	A2040520	A2240520	0.555
1 1/2"	25	150	1.34	A2040524	A2240524	0.695
2"	18	108	1.46	A2040532	A2240532	0.975
2 1/2"	28	56	1.73	A2040540	A2240540	1.765
3"	21	42	1.81	A2040548	A2240548	2.625
4"	7	21	2.08	A2040564	A2240564	4.335

**Locknuts**

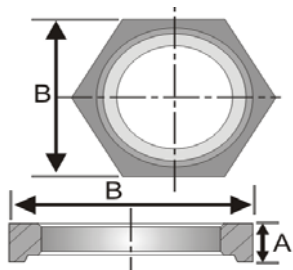

Size	Inner Carton	Master Case	"A" Inch	"B" Inch	Black Item Number	Galv. Item Number	Approx. Wgt. Ea / lbs.
1/8"	250	3000	0.19	0.71	A2040602	A2240602	0.024
1/4"	125	1500	0.26	0.84	A2040604	A2240604	0.040
3/8"	125	1500	0.28	1.00	A2040606	A2240606	0.045
1/2"	100	1200	0.31	1.18	A2040608	A2240608	0.065
3/4"	60	720	0.35	1.43	A2040612	A2240612	0.125
1"	40	480	0.39	1.75	A2040616	A2240616	0.175
1 1/4"	30	360	0.43	2.10	A2040620	A2240620	0.285
1 1/2"	45	270	0.47	2.12	A2040624	A2240624	0.265
2"	25	150	0.53	2.88	A2040632	A2240632	0.562
2 1/2"	20	80	0.59	3.50	A2040640	A2240640	1.135
3"	20	60	0.67	4.27	A2040648	A2240648	1.342
4"	7	28	0.80	5.39	A2040664	A2240664	2.572

**MSI Malleable Iron Pipe Fitting Specifications**

800-678-2544 phone 800-678-0857 fax www.msi-products.com mssales@msi-products.com

THREADS: ANSI / ASME B1.20.1 DIMENSIONS: ANSI B16.3 MATERIAL: ASTM A197

**Hex Bushings**

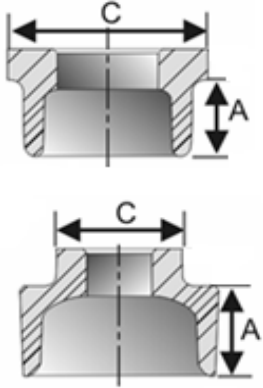

Size	Inner Carton	Master Case	"A" Inch	"C" Inch	Black Item Number	Galv. Item Number	Approx. Wgt. Ea / lbs.
1/4" x 1/8"	100	600	0.44	0.78	A204000402	A224000402	0.024
3/8" x 1/8"	100	600	0.48	0.78	A204000602	A224000602	0.037
3/8" x 1/4"	100	600	0.48	0.78	A204000604	A224000604	0.042
1/2" x 1/8"	100	600	0.56	0.95	A204000802	A224000802	0.095
1/2" x 1/4"	100	600	0.56	0.95	A204000804	A224000804	0.075
1/2" x 3/8"	100	600	0.56	0.95	A204000806	A224000806	0.066
3/4" x 1/8"	50	600	0.63	1.02	A204001202	A224001202	0.165
3/4" x 1/4"	50	600	0.63	1.02	A204001204	A224001204	0.161
3/4" x 3/8"	50	600	0.63	1.02	A204001206	A224001206	0.143
3/4" x 1/2"	50	600	0.63	1.02	A204001208	A224001208	0.099
1" x 1/4"	50	400	0.75	1.14	A204001604	A224001604	0.190
1" x 3/8"	50	400	0.75	1.14	A204001606	A224001606	0.238
1" x 1/2"	50	400	0.75	1.14	A204001608	A224001608	0.207
1" x 3/4"	50	400	0.75	1.14	A204001612	A224001612	0.172
1 1/4" x 1/4"	30	240	0.80	1.22	A204002004	A224002004	0.306
1 1/4" x 3/8"	30	240	0.80	1.22	A204002006	A224002006	0.432
1 1/4" x 1/2"	30	240	0.80	1.22	A204002008	A224002008	0.291
1 1/4" x 3/4"	30	240	0.80	1.22	A204002012	A224002012	0.355
1 1/4" x 1"	30	240	0.80	1.22	A204002016	A224002016	0.293
1 1/2" x 1/4"	25	150	0.83	1.22	A204002404	A224002404	0.646
1 1/2" x 3/8"	25	150	0.83	1.22	A204002406	A224002406	0.639
1 1/2" x 1/2"	25	150	0.83	1.22	A204002408	A224002408	0.397
1 1/2" x 3/4"	25	150	0.83	1.22	A204002412	A224002412	0.386
1 1/2" x 1"	25	150	0.83	1.22	A204002416	A224002416	0.463
1 1/2" x 1 1/4"	25	150	0.83	1.22	A204002420	A224002420	0.322
2" x 3/8"	20	120	0.88	1.38	A204003206	A224003206	0.948
2" x 1/2"	20	120	0.88	1.38	A204003208	A224003208	0.838
2" x 3/4"	20	120	0.88	1.38	A204003212	A224003212	0.631
2" x 1"	20	120	0.88	1.38	A204003216	A224003216	0.670
2" x 1 1/4"	20	120	0.88	1.38	A204003220	A224003220	0.732
2" x 1 1/2"	20	120	0.88	1.38	A204003224	A224003224	0.703
2 1/2" x 1/2"	15	60	1.07	1.57	A204004008	A224004008	1.572
2 1/2" x 3/4"	15	60	1.07	1.57	A204004012	A224004012	1.543
2 1/2" x 1"	15	60	1.07	1.57	A204004016	A224004016	1.515
2 1/2" x 1 1/4"	15	60	1.07	1.57	A204004020	A224004020	1.415
2 1/2" x 1 1/2"	15	60	1.07	1.57	A204004024	A224004024	1.376
2 1/2" x 2"	15	60	1.07	1.57	A204004032	A224004032	1.109
3" x 1"	12	48	1.14	1.73	A204004816	A224004816	1.466
3" x 1 1/4"	12	48	1.14	1.73	A204004820	A224004820	2.227
3" x 1 1/2"	12	48	1.14	1.73	A204004824	A224004824	1.923



**MSI Malleable Iron Pipe Fitting Specifications**

800-678-2544 phone 800-678-0857 fax www.msi-products.com msisales@msi-products.com

THREADS: ANSI / ASME B1.20.1 DIMENSIONS: ANSI B16.3 MATERIAL: ASTM A197

**Hex Bushings**

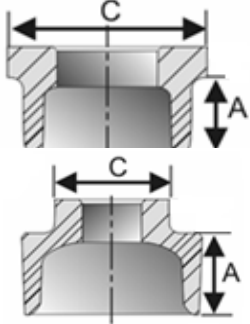

Size	Inner Carton	Master Case	"A" Inch	"C" Inch	Black Item Number	Galv. Item Number	Approx. Wgt. Ea / lbs.
3" x 2"	12	48	1.14	1.73	A204004832	A224004832	1.922
3" x 2 1/2"	12	48	1.14	1.73	A204004840	A224004840	1.504
4" x 3/4"	5	20	1.22	2.00	A204006412	A224006412	3.309
4" x 1"	5	20	1.22	2.00	A204006416	A224006416	2.588
4" x 1 1/4"	5	20	1.22	2.00	A204006420	A224006420	3.624
4" x 1 1/2"	5	20	1.22	2.00	A204006424	A224006424	3.915
4" x 2"	5	20	1.22	2.00	A204006432	A224006432	2.897
4" x 2 1/2"	5	20	1.22	2.00	A204006440	A224006440	2.773
4" x 3"	5	20	1.22	2.00	A204006448	A224006448	3.034

**Square Head Plugs**

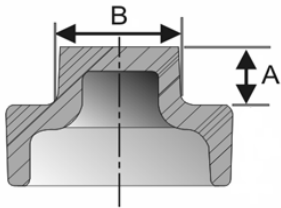

Size	Inner Carton	Master Case	"A" Inch	"B" Inch	Black Item Number	Galv. Item Number	Approx. Wgt. Ea / lbs.
1/8"	300	3600	0.24	0.28	A2050102	A2250102	0.015
1/4"	150	1800	0.28	0.37	A2050104	A2250104	0.029
3/8"	100	1200	0.31	0.43	A2050006	A2250006	0.051
1/2"	50	600	0.38	0.56	A2050008	A2250008	0.086
3/4"	30	360	0.44	0.63	A2050012	A2250012	0.132
1"	20	240	0.50	0.81	A2050016	A2250016	0.220
1 1/4"	40	240	0.56	0.93	A2050020	A2250020	0.399
1 1/2"	30	180	0.62	1.13	A2050024	A2250024	0.461
2"	20	120	0.68	1.31	A2050032	A2250032	0.741
2 1/2"	16	64	0.74	1.50	A2050040	A2250040	1.246
3"	16	48	0.80	1.69	A2050048	A2250048	1.693
4"	8	16	1.00	2.32	A2050064	A2250064	2.705

**Extension Pieces**

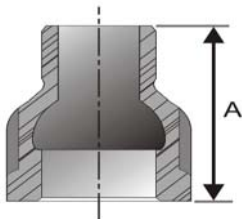

Size	Inner Carton	Master Case	"A" Inch	"B" Inch	Black Item Number	Galv. Item Number	Approx. Wgt. Ea / lbs.
1/2"	50	600	1.38	0.98	A2040408	A2240408	0.159
3/4"	40	320	1.69	1.18	A2040412	A2240412	0.280
1"	30	180	2.16	1.50	A2040416	A2240416	0.441
1 1/4"	30	120	2.36	1.61	A2040420	A2240420	0.661
1 1/2"	20	80	2.48	1.73	A2040424	A2240424	0.875
2"	15	60	2.75	1.81	A2040432	A2240432	1.323



# MSI Malleable Iron Pipe Fitting Specifications

800-678-2544 phone 800-678-0857 fax www.msi-products.com msisales@msi-products.com

THREADS: ANSI / ASME B1.20.1 DIMENSIONS: ANSI B16.3 MATERIAL: ASTM A197

## Reducer Coupling

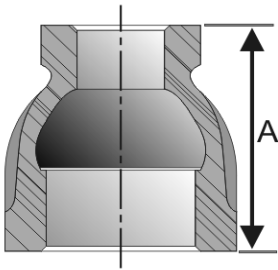

Size	Inner Carton	Master Case	"A" Inch	Black Item Number	Galv. Item Number	Approx. Wgt. Ea / lbs.
1/4" x 1/8"	50	600	1.02	A203080402	A223080402	0.0772
3/8" x 1/8"	35	420	1.14	A203080602	A223080602	0.1014
3/8" x 1/4"	30	360	1.14	A203080604	A223080604	0.1168
1/2" x 1/8"	50	600	1.34	A203080802	A223080802	0.1662
1/2" x 1/4"	50	600	1.34	A203080804	A223080804	0.1543
1/2" x 3/8"	40	480	1.34	A203080806	A223080806	0.1631
3/4" x 1/4"	30	360	1.50	A203081204	A223081204	0.2116
3/4" x 3/8"	30	360	1.50	A203081206	A223081206	0.2227
3/4" x 1/2"	60	360	1.50	A203081208	A223081208	0.2866
1" x 1/4"	45	270	1.73	A203081604	A223081604	0.3704
1" x 3/8"	30	240	1.73	A203081606	A223081606	0.3483
1" x 1/2"	30	240	1.73	A203081608	A223081608	0.3682
1" x 3/4"	25	200	1.73	A203081612	A223081612	0.4057
1 1/4" x 1/2"	25	150	2.00	A203082008	A223082008	0.5556
1 1/4" x 3/4"	25	150	2.00	A203082012	A223082012	0.6041
1 1/4" x 1"	15	120	2.00	A203082016	A223082016	0.6592
1 1/2" x 3/8"	30	120	2.24	A203082406	A223082406	0.5886
1 1/2" x 1/2"	20	120	2.24	A203082408	A223082408	0.7716
1 1/2" x 3/4"	15	120	2.24	A203082412	A223082412	0.7893
1 1/2" x 1"	25	100	2.24	A203082416	A223082416	0.8444
1 1/2" x 1 1/4"	12	96	2.24	A203082420	A223082420	0.8642
2" x 3/8"	15	90	2.79	A203083206	A223083206	0.9700
2" x 1/2"	14	84	2.79	A203083208	A223083208	1.1222
2" x 3/4"	14	84	2.79	A203083212	A223083212	1.1133
2" x 1"	14	84	2.79	A203083216	A223083216	1.2809
2" x 1 1/4"	12	72	2.79	A203083220	A223083220	1.3051
2" x 1 1/2"	12	72	2.79	A203083224	A223083224	1.4065
2 1/2" x 1/2"	20	40	3.26	A203084008	A223084008	1.7152
2 1/2" x 3/4"	20	40	3.26	A203084012	A223084012	1.6006
2 1/2" x 1"	20	40	3.26	A203084016	A223084016	1.8387
2 1/2" x 1 1/4"	20	40	3.26	A203084020	A223084020	1.8254
2 1/2" x 1 1/2"	20	40	3.26	A203084024	A223084024	1.7417
2 1/2" x 2"	20	40	3.26	A203084032	A223084032	1.7924
3" x 3/4"	16	48	3.70	A203084812	A223084812	2.2046
3" x 1"	16	32	3.70	A203084816	A223084816	2.0600
3" x 1 1/4"	16	32	3.70	A203084820	A223084820	2.0084
3" x 1 1/2"	16	32	3.70	A203084824	A223084824	2.1848
3" x 2"	16	32	3.70	A203084832	A223084832	2.2664
3" x 2 1/2"	12	24	3.70	A203084840	A223084840	3.5142
4" x 1"	6	18	4.37	A203086416	A223086416	3.9705
4" x 1 1/4"	6	18	4.37	A203086420	A223086420	3.6619
4" x 1 1/2"	6	18	4.37	A203086424	A223086424	3.8405
4" x 2"	4	12	4.37	A203086432	A223086432	4.9692
4" x 2 1/2"	6	18	4.37	A203086440	A223086440	4.0168
4" x 3"	4	12	4.37	A203086448	A223086448	4.0764

MSI Malleable Iron Pipe Fittings Meet the following Specifications: ASME B16.3; ASTM A197; ASME B1.20.1





# MSI Malleable Iron Pipe Fitting Specifications

800-678-2544 phone 800-678-0857 fax www.msi-products.com msisales@msi-products.com

THREADS: ANSI / ASME B1.20.1 DIMENSIONS: ANSI B16.3 MATERIAL: ASTM A197

## Reducing Elbows

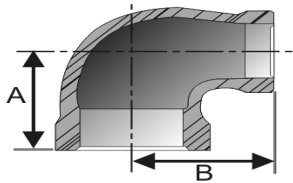

Size	Inner Carton	Master Case	"A" Inch	"B" Inch	Black Item Number	Galv. Item Number	Approx. Wgt. Ea / lbs.
1/4" x 1/8"	40	480	0.75	0.75	A201020402	A221020402	0.097
3/8" x 1/8"	70	840	0.83	0.87	A201020602	A221020602	0.128
3/8" x 1/4"	60	720	0.87	0.91	A201020604	A221020604	0.141
1/2" x 1/4"	40	480	0.98	0.98	A201020804	A221020804	0.176
1/2" x 3/8"	50	400	1.02	1.02	A201020806	A221020806	0.214
3/4" x 1/4"	40	320	1.06	1.06	A201021204	A221021204	0.245
3/4" x 3/8"	25	300	1.10	1.10	A201021206	A221021206	0.276
3/4" x 1/2"	30	240	1.18	1.22	A201021208	A221021208	0.317
1" x 3/8"	40	240	1.18	1.26	A201021606	A221021606	0.390
1" x 1/2"	30	180	1.26	1.34	A201021608	A221021608	0.445
1" x 3/4"	25	150	1.38	1.42	A201021612	A221021612	0.520
1 1/4" x 1/2"	35	140	1.34	1.54	A201022008	A221022008	0.637
1 1/4" x 3/4"	15	120	1.42	1.61	A201022012	A221022012	0.703
1 1/4" x 1"	10	80	1.57	1.65	A201022016	A221022016	0.809
1 1/2" x 1/2"	25	100	1.38	1.65	A201022408	A221022408	0.926
1 1/2" x 3/4"	15	90	1.54	1.77	A201022412	A221022412	0.739
1 1/2" x 1"	10	80	1.65	1.81	A201022416	A221022416	0.661
1 1/2" x 1 1/4"	15	60	1.81	1.89	A201022420	A221022420	1.268
2" x 1/2"	15	60	1.50	1.89	A201023208	A221023208	0.996
2" x 3/4"	10	60	1.61	1.97	A201023212	A221023212	1.213
2" x 1"	14	56	1.73	1.97	A201023216	A221023216	1.226
2" x 1 1/4"	10	40	1.89	2.08	A201023220	A221023220	1.431
2" x 1-1/2"	10	40	2.04	2.16	A201023224	A221023224	1.367
2-1/2" x 3/4"	10	40	1.73	2.32	A201024012	A221024012	1.742
2-1/2" x 1"	8	32	1.89	2.40	A201024016	A221024016	2.183
2-1/2" x 1 1/4"	8	24	2.09	2.48	A201024020	A221024020	2.123
2-1/2" x 1 1/2"	8	24	2.16	2.48	A201024024	A221024024	2.205
2-1/2" x 2"	8	24	2.40	2.60	A201024032	A221024032	2.701
3" x 1"	8	24	2.16	2.64	A201024816	A221024816	2.725
3" x 1 1/4"	5	24	2.16	2.71	A201024820	A221024820	2.943
3" x 1 1/2"	5	20	2.28	2.79	A201024824	A221024824	3.031
3" x 2"	6	18	2.52	2.87	A201024832	A221024832	3.086
3" x 2 1/2"	8	16	2.83	2.99	A201024840	A221024840	3.880
4" x 1 1/2"	1	12	2.48	3.38	A201026424	A221026424	5.582
4" x 2"	1	12	2.76	3.42	A201026432	A221026432	5.690

MSI Malleable Iron Pipe Fittings Meet the following Specifications: ASME B16.3; ASTM A197; ASME B1.20.1



# MSI Malleable Iron Pipe Fitting Specifications

800-678-2544 phone 800-678-0857 fax www.msi-products.com msisales@msi-products.com

THREADS: ANSI / ASME B1.20.1 DIMENSIONS: ANSI B16.3 MATERIAL: ASTM A197

## Reducing Tees

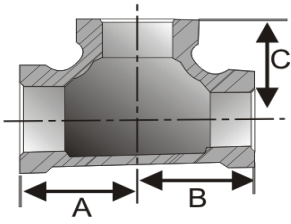

Size	Inner Carton	Master Case	"A" Inch	"B / C" Inch	Black Item Number	Galv. Item Number	Approx. Wgt. Ea / lbs.
1/4" x 1/4" x 1/8"	25	300	0.74	0.74 / 0.74	A20202040402	A22202040402	0.132
3/8" x 3/8" x 1/8"	60	480	0.83	0.83 / 0.87	A20202060602	A22202060602	0.161
3/8" x 3/8" x 1/4"	40	480	0.91	0.91 / 0.91	A20202060604	A22202060604	0.181
1/2" x 1/2" x 1/4"	25	300	0.94	0.94 / 0.94	A20202080804	A22202080804	0.256
1/2" x 1/2" x 3/8"	45	270	1.02	1.02 / 1.02	A20202080806	A22202080806	0.287
1/2" x 1/2" x 3/4"	30	180	1.22	1.22 / 1.18	A20202080812	A22202080812	0.430
1/2" x 1/2" x 1"	40	160	1.34	1.34 / 1.26	A20202080816	A22202080816	0.485
3/4" x 1/2" x 1/2"	30	180	1.18	1.10 / 1.22	A20202120808	A22202120808	0.428
3/4" x 1/2" x 3/4"	40	160	1.22	1.30 / 1.22	A20202120812	A22202120812	0.507
3/4" x 3/4" x 1/4"	25	200	1.02	1.02 / 1.06	A20202121204	A22202121204	0.353
3/4" x 3/4" x 3/8"	30	180	1.10	1.10 / 1.10	A20202121206	A22202121206	0.403
3/4" x 3/4" x 1/2"	30	180	1.18	1.18 / 1.22	A20202121208	A22202121208	0.474
3/4" x 3/4" x 1"	20	120	1.42	1.42 / 1.38	A20202121216	A22202121216	0.668
3/4" x 3/4" x 1 1/4"	25	100	1.61	1.61 / 1.50	A20202121220	A22202121220	0.772
1" x 1/2" x 1/2"	20	120	1.28	1.10 / 1.34	A20202160808	A22202160808	0.485
1" x 1/2" x 3/4"	20	120	1.38	1.50 / 1.42	A20202160812	A22202160812	0.595
1" x 1/2" x 1"	15	90	1.50	1.34 / 1.50	A20202160816	A22202160816	0.741
1" x 3/4" x 1/2"	20	120	1.26	1.18 / 1.34	A20202161208	A22202161208	0.615
1" x 3/4" x 3/4"	25	100	1.38	1.30 / 1.42	A20202161212	A22202161212	0.664
1" x 3/4" x 1"	15	90	1.50	1.42 / 1.50	A20202161216	A22202161216	0.791
1" x 1" x 1/4"	25	150	1.10	1.10 / 1.22	A20202161604	A22202161604	0.525
1" x 1" x 3/8"	20	120	1.18	1.18 / 1.26	A20202161606	A22202161606	0.602
1" x 1" x 1/2"	15	120	1.26	1.26 / 1.34	A20202161608	A22202161608	0.703
1" x 1" x 3/4"	25	100	1.38	1.38 / 1.42	A20202161612	A22202161612	0.774
1" x 1" x 1 1/4"	15	15	1.65	1.65 / 1.57	A20202161620	A22202161620	0.915
1" x 1" x 1 1/2"	15	15	1.81	1.81 / 1.65	A20202161624	A22202161624	1.157
1" x 1" x 2"	12	12	2.00	2.00 / 1.93	A20202161632	A22202161632	1.455
1 1/4" x 1/2" x 1/2"	25	100	1.34	1.06 / 1.50	A20202200808	A22202200808	0.661
1 1/4" x 1/2" x 3/4"	25	100	1.46	1.18 / 1.57	A20202200812	A22202200812	0.794
1 1/4" x 1/2" x 1"	20	80	1.57	1.38 / 1.65	A20202200816	A22202200816	0.935
1 1/4" x 1/2" x 1 1/4"	10	60	1.77	1.50 / 1.77	A20202200820	A22202200820	1.080
1 1/4" x 3/4" x 1/2"	25	100	1.34	1.14 / 1.50	A20202201208	A22202201208	0.763
1 1/4" x 3/4" x 3/4"	10	80	1.42	1.30 / 1.61	A20202201212	A22202201212	0.705
1 1/4" x 3/4" x 1"	10	80	1.57	1.42 / 1.65	A20202201216	A22202201216	0.968
1 1/4" x 3/4" x 1 1/4"	10	60	1.77	1.61 / 1.77	A20202201220	A22202201220	1.160
1 1/4" x 1" x 1/2"	18	72	1.34	1.26 / 1.50	A20202201608	A22202201608	0.750
1 1/4" x 1" x 3/4"	18	72	1.42	1.38 / 1.61	A20202201612	A22202201612	0.906
1 1/4" x 1" x 1"	18	72	1.57	1.50 / 1.61	A20202201616	A22202201616	0.970
1 1/4" x 1" x 1 1/4"	10	60	1.77	1.65 / 1.77	A20202201620	A22202201620	1.146
1 1/4" x 1 1/4" x 3/8"	20	80	1.30	1.30 / 1.42	A20202202006	A22202202006	0.849
1 1/4" x 1 1/4" x 1/2"	20	80	1.34	1.34 / 1.50	A20202202008	A22202202008	0.970
1 1/4" x 1 1/4" x 3/4"	12	72	1.42	1.42 / 1.81	A20202202012	A22202202012	1.005
1 1/4" x 1 1/4" x 1"	16	64	1.57	1.57 / 1.65	A20202202016	A22202202016	1.100
1 1/4" x 1 1/4" x 1 1/2"	14	56	1.89	1.89 / 1.81	A20202202024	A22202202024	1.453



# MSI Malleable Iron Pipe Fitting Specifications

800-678-2544 phone 800-678-0857 fax www.msi-products.com msisales@msi-products.com

THREADS: ANSI / ASME B1.20.1 DIMENSIONS: ANSI B16.3 MATERIAL: ASTM A197

## Reducing Tees

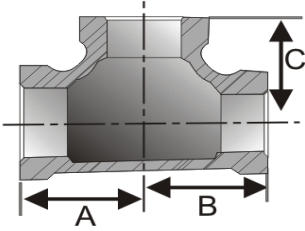

Size	Inner Carton	Master Case	"A" Inch	"B / C" Inch	Black Item Number	Galv. Item Number	Approx. Wgt. Ea / lbs.
1 1/4" x 1 1/4" x 2"	10	40	2.13	2.13 / 1.89	A20202202032	A22202202032	1.742
1 1/2" x 1/2" x 1 1/2"	12	48	1.97	1.65 / 1.97	A20202240824	A22202240824	1.435
1 1/2" x 3/4" x 1 1/2"	12	48	1.97	1.73 / 1.97	A20202241224	A22202241224	1.343
1 1/2" x 1" x 1 1/2"	14	56	1.97	1.81 / 1.97	A20202241624	A22202241624	1.367
1 1/2" x 1 1/4" x 1/2"	8	64	1.42	1.43 / 1.65	A20202242008	A22202242008	1.038
1 1/2" x 1 1/4" x 3/4"	8	64	1.50	1.42 / 1.73	A20202242012	A22202242012	1.036
1 1/2" x 1 1/4" x 1"	14	56	1.65	1.57 / 1.81	A20202242016	A22202242016	1.204
1 1/2" x 1 1/4" x 1 1/4"	12	48	1.81	1.77 / 1.89	A20202242020	A22202242020	1.389
1 1/2" x 1 1/4" x 1 1/2"	10	40	1.97	1.89 / 1.97	A20202242024	A22202242024	1.440
1 1/2" x 1 1/2" x 2"	8	32	2.17	2.17 / 2.04	A20202242432	A22202242432	1.984
1 1/2" x 1 1/2" x 3/8"	18	72	1.34	1.34 / 1.57	A20202242406	A22202242406	0.981
1 1/2" x 1 1/2" x 1/2"	18	72	1.42	1.42 / 1.65	A20202242408	A22202242408	1.030
1 1/2" x 1 1/2" x 3/4"	10	60	1.42	1.42 / 1.61	A20202242412	A22202242412	1.250
1 1/2" x 1 1/2" x 1"	13	52	1.57	1.57 / 1.65	A20202242416	A22202242416	1.409
1 1/2" x 1 1/2" x 1 1/4"	15	45	1.81	1.81 / 1.89	A20202242420	A22202242420	1.579
2" x 1/2" x 2"	8	32	2.25	1.89 / 2.25	A20202320832	A22202320832	2.037
2" x 3/4" x 2"	8	32	2.28	1.97 / 2.28	A20202321232	A22202321232	1.984
2" x 1" x 1 1/2"	10	40	2.00	1.81 / 2.17	A20202321624	A22202321624	1.768
2" x 1" x 2"	8	32	2.28	2.05 / 2.28	A20202321632	A22202321632	1.953
2" x 1 1/4" x 1 1/4"	6	36	1.89	1.77 / 2.13	A20202322020	A22202322020	1.543
2" x 1 1/4" x 1 1/2"	8	32	2.05	1.89 / 2.17	A20202322024	A22202322024	1.698
2" x 1 1/4" x 2"	13	26	2.28	2.17 / 2.28	A20202322032	A22202322032	2.205
2" x 1 1/2" x 3/4"	10	40	1.57	1.50 / 1.97	A20202322412	A22202322412	1.376
2" x 1 1/2" x 1"	10	40	1.73	1.65 / 2.05	A20202322416	A22202322416	1.572
2" x 1 1/2" x 1 1/4"	8	32	1.89	1.81 / 2.13	A20202322420	A22202322420	1.698
2" x 1 1/2" x 1 1/2"	8	32	2.05	1.97 / 2.17	A20202322424	A22202322424	1.812
2" x 1 1/2" x 2"	10	30	2.28	2.17 / 2.28	A20202322432	A22202322432	2.277
2" x 2" x 3/8"	10	40	1.46	1.46 / 1.81	A20202323206	A22202323206	1.455
2" x 2" x 1/2"	10	40	1.50	1.50 / 1.89	A20202323208	A22202323208	1.614
2" x 2" x 3/4"	10	40	1.57	1.57 / 1.97	A20202323212	A22202323212	1.777
2" x 2" x 1"	12	36	1.73	1.73 / 2.05	A20202323216	A22202323216	1.975
2" x 2" x 1 1/4"	8	32	1.89	1.89 / 2.13	A20202323220	A22202323220	1.925
2" x 2" x 1 1/2"	8	32	2.05	2.05 / 2.17	A20202323224	A22202323224	2.081
2" x 2" x 2 1/2"	8	16	2.60	2.60 / 2.40	A20202323240	A22202323240	3.269
2 1/2" x 2" x 2"	11	22	2.40	2.24 / 2.60	A20202403232	A22202403232	3.192
2 1/2" x 2" x 2 1/2"	8	16	2.72	2.60 / 2.72	A20202403240	A22202403240	4.079
2 1/2" x 2 1/2" x 1/2"	8	24	1.61	1.61 / 2.24	A20202404008	A22202404008	2.608
2 1/2" x 2 1/2" x 3/4"	8	24	1.73	1.73 / 2.32	A20202404012	A22202404012	2.853
2 1/2" x 2 1/2" x 1"	8	24	1.86	1.86 / 2.36	A20202404016	A22202404016	2.941
2 1/2" x 2 1/2" x 1 1/4"	10	20	2.05	2.05 / 2.44	A20202404020	A22202404020	2.959
2 1/2" x 2 1/2" x 1 1/2"	5	15	2.16	2.16 / 2.48	A20202404024	A22202404024	3.389
2 1/2" x 2 1/2" x 2"	8	16	2.40	2.40 / 2.60	A20202404032	A22202404032	3.898

MSI Malleable Iron Pipe Fittings Meet the following Specifications: ASME B16.3; ASTM A197; ASME B1.20.1



# MSI Malleable Iron Pipe Fitting Specifications

800-678-2544 phone 800-678-0857 fax www.msi-products.com msisales@msi-products.com

THREADS: ANSI / ASME B1.20.1 DIMENSIONS: ANSI B16.3 MATERIAL: ASTM A197

## Reducing Tees

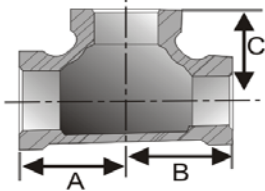

Size	Inner Carton	Master Case	"A" Inch	"B / C " Inch	Black Item Number	Galv. Item Number	Approx. Wgt. Ea / lbs.
3" x 3" x 1/2"	6	18	2.00	2.00 / 2.68	A20202484808	A22202484808	2.822
3" x 3" x 3/4"	6	18	2.00	2.00 / 2.68	A20202484812	A22202484812	3.175
3" x 3" x 1"	5	15	2.00	2.00 / 2.64	A20202484816	A22202484816	3.497
3" x 3" x 1 1/4"	6	12	2.17	2.17 / 2.76	A20202484820	A22202484820	3.836
3" x 3" x 1 1/2"	6	12	2.28	2.28 / 2.80	A20202484824	A22202484824	4.806
3" x 3" x 2"	6	12	2.52	2.52 / 2.87	A20202484832	A22202484832	4.553
3" x 3" x 2 1/2"	6	12	2.83	2.83 / 2.99	A20202484840	A22202484840	5.137
4" x 4" x 1"	2	8	2.20	2.20 / 3.19	A20202646416	A22202646416	5.800
4" x 4" x 1 1/4"	2	8	2.40	2.40 / 3.27	A20202646420	A22202646420	6.515
4" x 4" x 1 1/2"	2	8	2.52	2.52 / 3.30	A20202646424	A22202646424	6.636
4" x 4" x 2"	4	8	2.76	2.76 / 3.38	A20202646432	A22202646432	6.978
4" x 4" x 2 1/2"	2	6	3.03	3.03 / 3.50	A20202646440	A22202646440	9.083
4" x 4" x 3"	2	6	3.30	3.30 / 3.62	A20202646448	A22202646448	8.175

## Side Outlet Tees

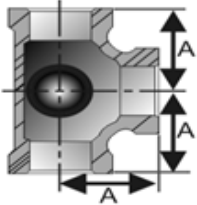

Size	Inner Carton	Master Case	"A" Inch	Black Item Number	Galv. Item Number	Approx. Wgt. Ea / lbs.
1/2"	45	270	1.10	A2020808	A2220808	0.379
3/4"	20	160	1.30	A2020812	A2220812	0.578
1"	20	80	1.50	A2020816	A2220816	0.891
1 1/4"	15	45	1.77	A2020820	A2220820	1.389
1 1/2"	12	36	1.97	A2020824	A2220824	1.653
2"	12	24	2.28	A2020832	A2220832	2.582

## Floor Flanges

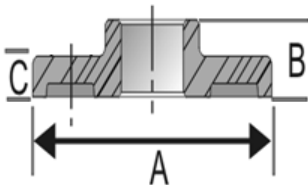

Size	Inner Carton	Master Case	"A" Inch	"B / C " Inch	Black Item Number	Galv. Item Number	Approx. Wgt. Ea / lbs.
3/8"	25	150	2.83	0.47 / 0.20	A2063006	A2263006	0.608
1/2"	25	100	2.95	0.59 / 0.20	A2063008	A2263008	0.730
3/4"	15	90	3.35	0.59 / 0.20	A2063012	A2263012	0.752
1"	15	60	3.66	0.75 / 0.20	A2063016	A2263016	1.005
1 1/4"	10	60	3.97	0.87 / 0.24	A2063020	A2263020	1.082
1 1/2"	8	48	4.37	0.87 / 0.24	A2063024	A2263024	1.709
2"	8	32	5.66	0.87 / 0.31	A2063032	A2263032	3.236

**300lb. 90° Elbows**

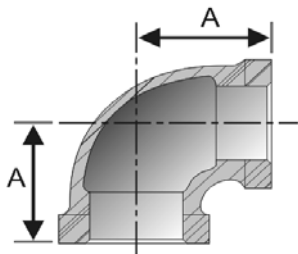

Size	Inner Carton	Master Case	"A" Inch	Black Item Number	Galv. Item Number	Approx. Wgt. Ea / lbs.
1/4"	180	360	0.94	A2910004	A7210004	0.205
3/8"	120	240	1.06	A2910006	A7210006	0.298
1/2"	40	80	1.25	A2910008	A7210008	0.448
3/4"	30	60	1.44	A2910012	A7210012	0.723
1"	20	40	1.63	A2910016	A7210016	1.160
1 1/4"	12	24	1.94	A2910020	A7210020	1.698
1 1/2"	8	16	2.13	A2910024	A7210024	2.452
2"	6	12	2.49	A2910032	A7210032	3.761
2 1/2"	4	8	2.94	A2910040	A7210040	6.230
3"	2	4	3.38	A2910048	A7210048	9.405
4"	1	2	4.13	A2910064	A7210064	14.083

**300lb. 45° Elbows**

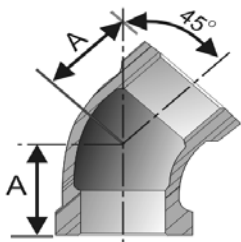

Size	Inner Carton	Master Case	"A" Inch	Black Item Number	Galv. Item Number	Approx. Wgt. Ea / lbs.
1/4"	180	360	0.81	A2910404	A7210404	0.192
3/8"	120	240	0.88	A2910406	A7210406	0.284
1/2"	40	80	0.99	A2910408	A7210408	0.423
3/4"	30	60	1.13	A2910412	A7210412	0.683
1"	20	40	1.31	A2910416	A7210416	1.041
1 1/4"	12	24	1.50	A2910420	A7210420	1.691
1 1/2"	8	16	1.69	A2910424	A7210424	2.249
2"	6	12	1.99	A2910432	A7210432	3.620
2 1/2"	2	4	2.25	A2910440	A7210440	5.542
3"	1	2	2.49	A2910448	A7210448	8.684
4"	1	2	2.80	A2910464	A7210464	11.722

**300lb. 90° Street Elbows**

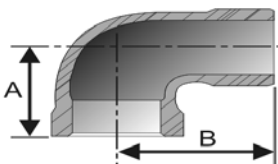

Size	Inner Carton	Master Case	"A" Inch	"B" Inch	Black Item Number	Galv. Item Number	Approx. Wgt. Ea / lbs.
1/4"	180	360	0.94	1.44	A2910604	A7210604	0.172
3/8"	120	240	1.06	1.63	A2910606	A7210606	0.258
1/2"	40	80	1.25	1.99	A2910608	A7210608	0.390
3/4"	30	60	1.44	2.19	A2910612	A7210612	0.628
1"	20	40	1.63	2.56	A2910616	A7210616	1.021
1 1/4"	12	24	1.94	2.87	A2910620	A7210620	1.678
1 1/2"	8	16	2.13	3.13	A2910624	A7210624	1.726
2"	6	12	2.49	3.69	A2910632	A7210632	3.633
2 1/2"	2	4	2.89	4.02	A2910640	A7210640	3.907
3"	1	2	3.35	4.72	A2910648	A7210648	7.438
4"	1	2	4.13	5.83	A2910664	A7210664	10.496

**MSI Malleable Iron Pipe Fitting Specifications**

800-678-2544 phone 800-678-0857 fax www.msi-products.com msisales@msi-products.com

THREADS: ANSI / ASME B1.20.1 DIMENSIONS: ANSI B16.3 MATERIAL: ASTM A197

**300lb. Tees**

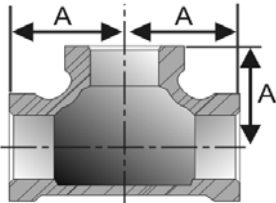

Size	Inner Carton	Master Case	"A" Inch	Black Item Number	Galv. Item Number	Approx. Wgt. Ea / lbs.
1/4"	120	240	0.94	A2920004	A7220004	0.289
3/8"	90	180	1.06	A2920006	A7220006	0.425
1/2"	30	60	1.25	A2920008	A7220008	0.655
3/4"	20	40	1.44	A2920012	A7220012	1.049
1"	12	24	1.63	A2920016	A7220016	1.570
1 1/4"	10	20	1.94	A2920020	A7220020	2.544
1 1/2"	6	12	2.13	A2920024	A7220024	3.316
2"	4	8	2.49	A2920032	A7220032	5.302
2 1/2"	2	4	2.94	A2920040	A7220040	8.314
3"	1	2	3.37	A2920048	A7220048	12.712
4"	1	2	4.13	A2920064	A7220064	18.964

**300lb. Couplings - Banded**

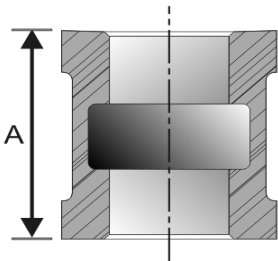

Size	Inner Carton	Master Case	"A" Inch	Black Item Number	Galv. Item Number	Approx. Wgt. Ea / lbs.
1/4"	200	400	1.37	A2930404	A7230404	0.163
3/8"	150	300	1.62	A2930406	A7230406	0.265
1/2"	40	80	1.87	A2930408	A7230408	0.412
3/4"	30	60	2.12	A2930412	A7230412	0.653
1"	20	40	2.37	A2930416	A7230416	1.014
1 1/4"	12	24	2.87	A2930420	A7230420	1.656
1 1/2"	12	24	2.16	A2930424	A7230424	2.015
2"	6	12	2.87	A2930432	A7230432	3.483
2 1/2"	4	8	4.12	A2930440	A7230440	5.342
3"	2	4	4.12	A2930448	A7230448	7.291
4"	2	4	4.25	A2930464	A7230464	10.448

**300lb. Caps**

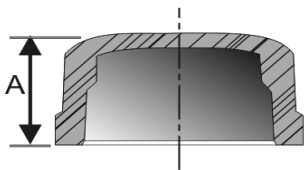

Size	Inner Carton	Master Case	"A" Inch	Black Item Number	Galv. Item Number	Approx. Wgt. Ea / lbs.
3/8"	120	240	0.83	A2940506	A7240506	0.137
1/2"	80	160	0.98	A2940508	A7240508	0.223
3/4"	50	100	1.08	A2940512	A7240512	0.342
1"	30	60	1.26	A2940516	A7240516	0.534
1 1/4"	20	40	1.38	A2940520	A7240520	0.814
1 1/2"	15	30	1.43	A2940524	A7240524	1.082
2"	10	20	1.68	A2940532	A7240532	1.845
2 1/2"	8	16	2.21	A2940540	A7240540	3.003
3"	5	10	2.36	A2940548	A7240548	4.370
4"	3	6	2.76	A2940564	A7240564	6.916



**MSI Malleable Iron Pipe Fitting Specifications**

800-678-2544 phone 800-678-0857 fax www.msi-products.com msisales@msi-products.com

THREADS: ANSI / ASME B1.20.1 DIMENSIONS: ANSI B16.3 MATERIAL: ASTM A197

**300lb. Unions**

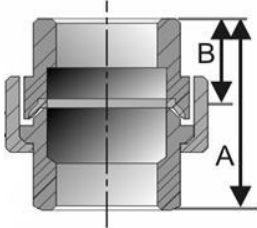

Size	Inner Carton	Master Case	"A" Inch	"B" Inch	Black Item Number	Galv. Item Number	Approx. Wgt. Ea / lbs.
1/4"	120	240	1.65	0.84	A2940804	A7240804	0.333
3/8"	90	180	1.80	0.90	A2940806	A7240806	0.465
1/2"	40	80	2.03	1.02	A2940808	A7240808	0.600
3/4"	30	60	2.25	1.12	A2940812	A7240812	0.844
1"	18	36	2.42	1.21	A2940816	A7240816	1.435
1 1/4"	12	24	2.80	1.40	A2940820	A7240820	2.097
1 1/2"	10	20	3.03	1.50	A2940824	A7240824	2.489
2"	6	12	3.43	1.72	A2940832	A7240832	4.096
2 1/2"	4	8	3.73	1.86	A2940840	A7240840	6.554
3"	3	6	4.45	2.24	A2940848	A7240848	10.587
4"	1	2	4.96	2.48	A2940864	A7240864	18.682

**300lb. Reducing Tees**

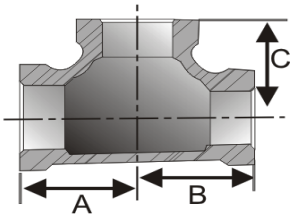

Size	Inner Carton	Master Case	"A" Inch	"B / C" Inch	Black Item Number	Galv. Item Number	Approx. Wgt. Ea / lbs.
3/4" x 3/4" x 1/2"	30	60	1.31	1.31 / 1.37	A29202121208	A72202121208	1.248
1" x 1" x 1/2"	16	32	1.44	1.44 / 1.49	A29202161608	A72202161608	1.270
1" x 1" x 3/4"	15	30	1.38	1.49 / 1.56	A29202161612	A72202161612	1.367
1 1/4" x 1 1/4" x 1/2"	12	24	1.50	1.50 / 1.69	A29202202008	A72202202008	2.022
1 1/4" x 1 1/4" x 3/4"	12	24	1.63	1.63 / 1.74	A29202202012	A72202202012	1.993
1 1/4" x 1 1/4" x 1"	12	24	1.74	1.74 / 1.82	A29202202016	A72202202016	2.218
1 1/2" x 1 1/2" x 1/2"	10	20	1.63	1.63 / 1.81	A29202242408	A72202242408	2.626
1 1/2" x 1 1/2" x 3/4"	10	20	1.69	1.69 / 1.88	A29202242412	A72202242412	2.716
1 1/2" x 1 1/2" x 1"	10	20	1.81	1.81 / 2.00	A29202242416	A72202242416	2.665
1 1/2" x 1 1/2" x 1 1/4"	8	16	2.00	2.00 / 2.06	A29202242420	A72202242420	3.045
2" x 2" x 1"	5	10	2.00	2.00 / 2.25	A29202323216	A72202323216	4.447
2" x 2" x 1 1/4"	5	10	2.13	2.13 / 2.38	A29202323220	A72202323220	4.363
2" x 2" x 1 1/2"	5	10	2.24	2.24 / 2.31	A29202323224	A72202323224	4.614
2 1/2" x 2 1/2" x 2"	4	8	2.69	2.69 / 2.75	A29202404032	A72202404032	3.320
3" x 3" x 2"	2	4	2.81	2.81 / 3.13	A29202646432	A72202484832	9.667



# MSI Malleable Iron Pipe Fitting Specifications

800-678-2544 phone 800-678-0857 fax www.msi-products.com msisales@msi-products.com

THREADS: ANSI / ASME B1.20.1 DIMENSIONS: ANSI B16.3 MATERIAL: ASTM A197

## 300lb. Reducer Coupling

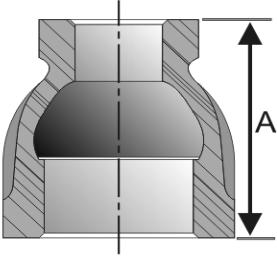

Size	Inner Carton	Master Case	"A" Inch	Black Item Number	Galv. Item Number	Weight Ea / (lb.)
1/2" x 1/4"	100	200	1.69	A293080804	A723080804	0.311
1/2" x 3/8"	100	200	1.69	A293080806	A723080806	0.340
3/4 x 3/8"	60	120	1.75	A293081206	A723081206	0.459
3/4 x 1/2"	60	120	1.75	A293081208	A723081208	0.496
1" x 1/2"	50	100	2.00	A293081608	A723081608	0.772
1" x 3/4"	40	80	2.00	A293081612	A723081612	0.853
1 1/4" x 1/2"	24	48	2.38	A293082008	A723082008	1.120
1 1/4" x 3/4"	20	40	2.38	A293082012	A723082012	1.204
1 1/4" x 1"	20	40	2.38	A293082016	A723082016	1.246
1 1/2" x 1/2"	24	48	2.69	A293082408	A723082408	1.475
1 1/2" x 3/4"	20	40	2.69	A293082412	A723082412	1.539
1 1/2" x 1"	18	36	2.69	A293082416	A723082416	1.629
1 1/2" x 1 1/4"	18	36	2.69	A293082420	A723082420	1.814
2" x 1/2"	12	24	3.19	A293083208	A723083208	2.460
2" x 3/4"	12	24	3.19	A293083212	A723083212	2.407
2" x 1"	12	24	3.19	A293083216	A723083216	2.463
2" x 1 1/4"	8	16	3.19	A293083220	A723083220	2.709
2" x 1 1/2"	4	16	3.19	A293083224	A723083224	2.758
2 1/2" x 1 1/2"	6	8	3.69	A293084024	A723084024	3.757
2 1/2" x 2"	6	12	3.69	A293084032	A723084032	4.376
3" x 2"	4	8	4.06	A293084832	A723084832	5.847
3" x 2 1/2"	4	8	4.06	A293084840	A723084840	6.288
4" x 3"	2	4	4.41	A293086448	A723086448	8.999

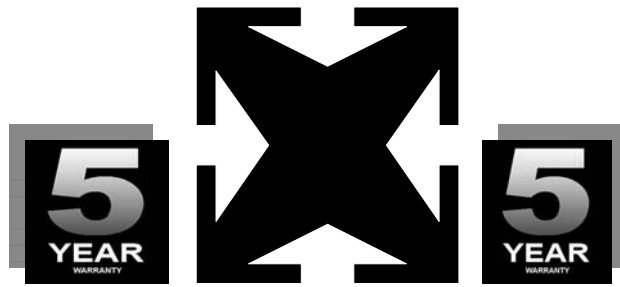

# **MSI 5 YEAR LIMITED WARRANTY**

MSI warrants to its initial purchaser only, that its products which are delivered to the initial purchaser will be of the kind described in the order or price list and will be free of defects in workmanship or material for a period of (5) five years from the date of delivery to MSI's initial purchaser.

Should any failure to conform to this warranty appear within (5) five years after the date of the initial delivery to MSI's initial purchaser, MSI will, upon written notification thereof and substantiation that the goods have been stored, installed, maintained and operated in accordance with recognized engineering and piping practices and industry standards, correct such defects by suitable replacement of product at our expense upon return of the defective product to MSI.

This warranty applies only during normal use that meets the above referenced conditions of installation and operation and is absolutely void if the product has been damaged after purchase or if it has been misused, repaired, altered or modified in any manner whatsoever. MSI shall not warranty any of its products if any portion of the product including without limitation, any component, gasket, housing or bolt has been modified, altered, remanufactured or replaced in any manner by any customer, user of the product or third party.

Correction of non-conformities, in the manner and for the period of time provided above, shall constitute fulfillment of all liabilities of MSI to MSI's initial purchaser, with respect to the goods, whether based on contract, negligence, strict tort or otherwise. It is the intention of MSI that no warranty of any kind, whether expressed or implied shall pass through MSI's initial purchaser to any other person or corporation.

No returns will be permitted unless prior written permission of MSI is first obtained. Buyers shall be responsible for all costs of transportation as well as any applicable restocking fees.

This warranty is exclusively for the benefit of MSI's initial purchaser of the product from MSI and to the extent prohibited by applicable law, the foregoing warranty is in lieu of all other warranties, express or implied, including but not limited to warranties of fitness or merchantability.

## **LIMITATIONS OF LIABILITY**

MSI shall not under any circumstances be liable for special or consequential damages such as, but not limited to, damage to loss of other property or equipment, loss of profits or revenue, cost of capital, cost of purchased or replacement goods, claims of customers of our initial purchaser, any labor cost or replacement of the product or damage caused by the product.

The remedies of MSI's initial purchaser and all others, set forth herein are exclusive and the liability of MSI with respect to same shall not, except as expressly provided herein, exceed the price of the MSI products on which such liability is based.