



# MERCHANT STEEL FITTINGS

Standard Merchant Steel Product Specifications



- ✘ *Manufactured in ISO9000:2000 Facility*
- ✘ *Plated Items Conform to RoHS Requirements*
- ✘ *Plated Items meet Federal Specification QQ-Z-325*
- ✘ *ASME B633 Clear Zinc Plating Specification*



800-678-2544 ☎ • 800-678-0857 📞 • [www.msi-products.com](http://www.msi-products.com)

*Pricing subject to change without notice. © Copyright 2009*



# MSI Merchant Steel Product Specifications



800-678-2544



800-678-0857

www.msi-products.com

Merchant Steel Bushings and Plugs Conform to **ASME B16.14 / NPTF Threads**

(RoHs) Plated Parts are manufactured from material compliant with EU Directive 2002/95/EC

## Square Head Plugs

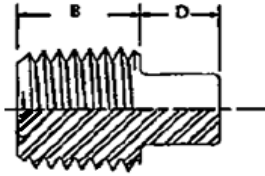

Size	"B"	"D"	Weight Per 100 Pieces	Inner Carton	Master Case	Steel Item Number	Zinc Plated Steel Number
1/16"	0.330	0.178	1.10	500	1000	A2150101	A2350101
1/8"	0.330	0.240	1.80	100	500	A2150102	A2350102
1/4"	0.445	0.280	3.50	100	500	A2150104	A2350104
3/8"	0.495	0.310	6.20	100	500	A2150106	A2350106
1/2"	0.590	0.380	11.50	100	500	A2150108	A2350108
3/4"	0.630	0.440	18.00	50	250	A2150112	A2350112
1"	0.750	0.500	34.00	25	100	A2150116	A2350116
1 1/4"	0.800	0.560	62.00	10	50	A2150120	A2350120
1 1/2"	0.830	0.620	82.00	10	50	A2150124	A2350124
2"	0.880	0.680	136.00	10	50	A2150132	A2350132

## Hex Head Plugs

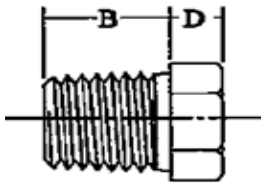

Size	"B"	"D"	Weight Per 100 Pieces	Inner Carton	Master Case	Steel Item Number	Zinc Plated Steel Number
1/16"	0.330	0.178	1.10	500	1000	A2150301	A2350301
1/8"	0.370	0.181	2.00	100	500	A2150302	A2350302
1/4"	0.560	0.181	4.00	100	500	A2150304	A2350304
3/8"	0.510	0.160	7.00	100	500	A2150306	A2350306
1/2"	0.610	0.190	13.00	100	500	A2150308	A2350308
3/4"	0.720	0.220	22.00	50	250	A2150312	A2350312
1"	0.750	0.250	37.00	25	100	A2150316	A2350316
1 1/4"	0.890	0.280	70.00	10	50	A2150320	A2350320

## Square Socket Plug

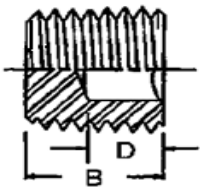

Size	"B"	"D"	Weight Per 100 Pieces	Inner Carton	Master Case	Steel Item Number	Zinc Plated Steel Number
1/16"	0.290	0.120	0.50	500	1000	A2150401	A2350401
1/8"	0.290	0.120	0.80	100	500	A2150402	A2350402
1/4"	0.445	0.190	2.00	100	500	A2150404	A2350404
3/8"	0.445	0.190	3.10	100	500	A2150406	A2350406
1/2"	0.590	0.250	6.60	100	500	A2150408	A2350408
3/4"	0.600	0.310	10.20	50	250	A2150412	A2350412
1"	0.750	0.380	21.50	25	100	A2150416	A2350416
1 1/4"	0.800	0.380	37.00	10	50	A2150420	A2350420
1 1/2"	0.830	0.406	44.50	10	50	A2150424	A2350424
2"	0.880	0.406	86.00	10	50	A2150432	A2350432

# MSI Merchant Steel Product Specifications



800-678-2544



800-678-0857

www.msi-products.com

Merchant Steel Bushings and Plugs Conform to **ASME B16.14 / NPTF Threads**

(RoHs) Plated Parts are manufactured from material compliant with EU Directive 2002/95/EC

## Hex Socket Plug

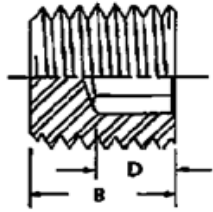

Size	"B"	"D"	Weight Per 100 Pieces	Inner Carton	Master Case	Steel Item Number	Zinc Plated Steel Number
1/16"	0.290	0.120	0.50	500	1000	A2150501	A2350501
1/8"	0.290	0.120	0.80	100	500	A2150502	A2350502
1/4"	0.445	0.190	2.00	100	500	A2150504	A2350504
3/8"	0.445	0.190	3.10	100	500	A2150506	A2350506
1/2"	0.590	0.250	6.60	100	500	A2150508	A2350508
3/4"	0.600	0.310	10.20	50	250	A2150512	A2350512
1"	0.750	0.380	21.50	25	100	A2150516	A2350516
1 1/4"	0.800	0.380	37.00	10	50	A2150520	A2350520
1 1/2"	0.830	0.406	44.50	10	50	A2150524	A2350524
2"	0.880	0.406	86.00	10	50	A2150532	A2350532

## Flush Hex Socket Plug (7/8" Taper)

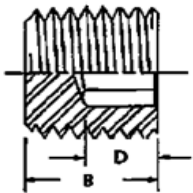

Size	"B"	"D"	Weight Per 100 Pieces	Inner Carton	Master Case	Steel Item Number	Zinc Plated Steel Number
1/16"	0.235	0.140	0.50	500	1000	A2150701	A2350701
1/8"	0.235	0.140	0.80	100	500	A2150702	A2350702
1/4"	0.391	0.218	2.00	100	500	A2150704	A2350704
3/8"	0.391	0.250	3.10	100	500	A2150706	A2350706
1/2"	0.516	0.312	6.60	100	500	A2150708	A2350708
3/4"	0.516	0.360	10.20	50	250	A2150712	A2350712
1"	0.641	0.360	21.50	25	100	A2150716	A2350716
1 1/4"	0.641	0.360	37.00	10	50	A2150720	A2350720

## Hex Bushings

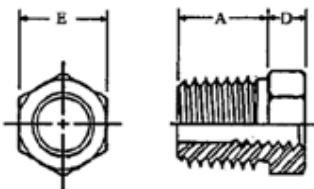

Size	"A"	"D"	"E"	Inner Carton	Master Case	Weight Per 100 Pieces	Steel Item Number	Zinc Plated Steel Number
1/4" x 1/8"	0.48	0.15	0.6250	25	100	2.00	A214000402	A234000402
3/8" x 1/8"	0.50	0.16	0.6875	25	100	5.00	A214000602	A234000602
3/8" x 1/4"	0.50	0.16	0.6875	25	100	3.00	A214000604	A234000604
1/2" x 1/8"	0.61	0.19	0.8750	25	100	9.50	A214000802	A234000802
1/2" x 1/4"	0.61	0.19	0.8750	25	100	8.50	A214000804	A234000804
1/2" x 3/8"	0.61	0.19	0.8750	25	100	5.50	A214000806	A234000806
3/4" x 1/8"	0.72	0.22	1.0625	25	100	19.50	A214001202	A234001202
3/4" x 1/4"	0.72	0.22	1.0625	25	100	16.00	A214001204	A234001204
3/4" x 3/8"	0.72	0.22	1.0625	25	100	14.00	A214001206	A234001206
3/4" x 1/2"	0.72	0.22	1.0625	25	100	10.00	A214001208	A234001208
1" x 1/8"	0.75	0.25	1.3125	25	100	35.00	A214001602	A234001602
1" x 1/4"	0.75	0.25	1.3125	25	100	31.00	A214001604	A234001604
1" x 3/8"	0.75	0.25	1.3125	25	100	30.00	A214001606	A234001606
1" x 1/2"	0.75	0.25	1.3125	25	100	25.00	A214001608	A234001608
1" x 3/4"	0.75	0.25	1.3125	25	100	15.00	A214001612	A234001612
1 1/4" x 1/4"	0.89	0.28	1.7500	25	100	66.00	A214002004	A234002004
1 1/4" x 3/8"	0.89	0.28	1.7500	25	100	65.00	A214002006	A234002006
1 1/4" x 1/2"	0.89	0.28	1.7500	25	100	63.00	A214002008	A234002008
1 1/4" x 3/4"	0.89	0.28	1.7500	25	100	55.00	A214002012	A234002012
1 1/4" x 1"	0.89	0.28	1.7500	25	100	45.00	A214002016	A234002016



# MSI Merchant Steel Product Specifications



800-678-2544



800-678-0857

www.msi-products.com

Merchant Steel Bushings and Plugs Conform to **ASME B16.14 / NPTF Threads**

(RoHs) Plated Parts are manufactured from material compliant with EU Directive 2002/95/EC

Face Bushings		Size	"A"	"B"	"C"	Inner Carton	Master Case	Weight Per 100 Pieces	Steel Item Number	Zinc Plated Steel Number
		1/4" x 1/8"	0.44	0.25	0.5625	25	100	1.00	A214010402	A234010402
		3/8" x 1/8"	0.48	0.25	0.6875	25	100	3.00	A214010602	A234010602
		3/8" x 1/4"	0.48	0.37	0.6875	25	100	2.00	A214010604	A234010604
		1/2" x 1/8"	0.56	0.25	0.8125	25	100	6.00	A214010802	A234010802
		1/2" x 1/4"	0.56	0.37	0.8125	25	100	5.00	A214010804	A234010804
		1/2" x 3/8"	0.56	0.41	0.8125	25	100	3.00	A214010806	A234010806
		3/4" x 1/8"	0.62	0.25	1.0625	25	100	12.00	A214011202	A234011202
		3/4" x 1/4"	0.62	0.37	1.0625	25	100	10.00	A214011204	A234011204
		3/4" x 3/8"	0.62	0.41	1.0625	25	100	8.00	A214011206	A234011206
		3/4" x 1/2"	0.62	0.50	1.0625	25	100	5.00	A214011208	A234011208
		1" x 1/4"	0.75	0.37	1.3125	25	100	21.00	A214011604	A234011604
		1" x 3/8"	0.75	0.41	1.3125	25	100	19.00	A214011606	A234011606
		1" x 1/2"	0.75	0.50	1.3125	25	100	15.00	A214011608	A234011608
		1" x 3/4"	0.75	0.52	1.3125	25	100	9.00	A214011612	A234011612
		1 1/4" x 1/2"	0.81	0.50	1.7500	25	100	32.00	A214012008	A234012008
		1 1/4" x 3/4"	0.81	0.52	1.7500	25	100	26.00	A214012012	A234012012
	1 1/4" x 1"	0.81	0.62	1.7500	25	100	16.00	A214012016	A234012016	

Hex Caps		Size	"A"	"B"	"D"	Inner Carton	Master Case	Weight Per 100 Pieces	Steel Item Number	Zinc Plated Steel Number
		1/8"	0.5625	0.530	0.250	100	500	2.00	A2140502	A2340502
		1/4"	0.6875	0.630	0.320	100	500	3.80	A2140504	A2340504
		3/8"	0.8125	0.690	0.360	100	500	7.30	A2140506	A2340506
		1/2"	1.0000	0.870	0.430	100	500	11.60	A2140508	A2340508
		3/4"	1.1875	0.970	0.500	50	250	15.80	A2140512	A2340512
		1"	1.5000	1.160	0.580	25	100	29.00	A2140516	A2340516

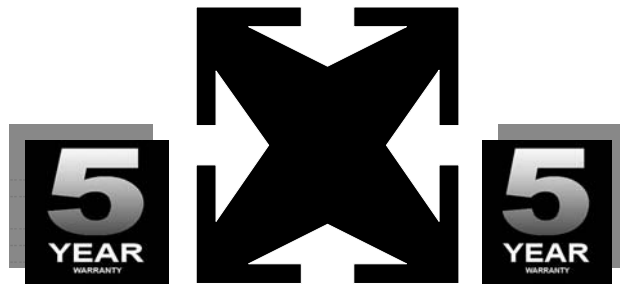

# **MSI 5 YEAR LIMITED WARRANTY**

MSI warrants to its initial purchaser only, that its products which are delivered to the initial purchaser will be of the kind described in the order or price list and will be free of defects in workmanship or material for a period of (5) five years from the date of delivery to MSI's initial purchaser.

Should any failure to conform to this warranty appear within (5) five years after the date of the initial delivery to MSI's initial purchaser, MSI will, upon written notification thereof and substantiation that the goods have been stored, installed, maintained and operated in accordance with recognized engineering and piping practices and industry standards, correct such defects by suitable replacement of product at our expense upon return of the defective product to MSI.

This warranty applies only during normal use that meets the above referenced conditions of installation and operation and is absolutely void if the product has been damaged after purchase or if it has been misused, repaired, altered or modified in any manner whatsoever. MSI shall not warranty any of its products if any portion of the product including without limitation, any component, gasket, housing or bolt has been modified, altered, remanufactured or replaced in any manner by any customer, user of the product or third party.

Correction of non-conformities, in the manner and for the period of time provided above, shall constitute fulfillment of all liabilities of MSI to MSI's initial purchaser, with respect to the goods, whether based on contract, negligence, strict tort or otherwise. It is the intention of MSI that no warranty of any kind, whether expressed or implied shall pass through MSI's initial purchaser to any other person or corporation.

No returns will be permitted unless prior written permission of MSI is first obtained. Buyers shall be responsible for all costs of transportation as well as any applicable restocking fees.

This warranty is exclusively for the benefit of MSI's initial purchaser of the product from MSI and to the extent prohibited by applicable law, the foregoing warranty is in lieu of all other warranties, express or implied, including but not limited to warranties of fitness or merchantability.

## **LIMITATIONS OF LIABILITY**

MSI shall not under any circumstances be liable for special or consequential damages such as, but not limited to, damage to loss of other property or equipment, loss of profits or revenue, cost of capital, cost of purchased or replacement goods, claims of customers of our initial purchaser, any labor cost or replacement of the product or damage caused by the product.

The remedies of MSI's initial purchaser and all others, set forth herein are exclusive and the liability of MSI with respect to same shall not, except as expressly provided herein, exceed the price of the MSI products on which such liability is based.