



✘ MSI 150# Stainless Steel Cast Threaded Pipe Fitting Specifications

800-678-2544 phone 800-678-0857 fax www.msi-products.com msisales@msi-products.com

THREADS: ANSI/ASME B1.20.1 MATERIAL :ASTM A351 (CF8/304 & CF8M /316)

MSI150# Stainless Cast Fittings Conform to ANSI 304/316 ; Threads conform to ASME B1.20.1; SSP114 Fittings also available

Full Couplings

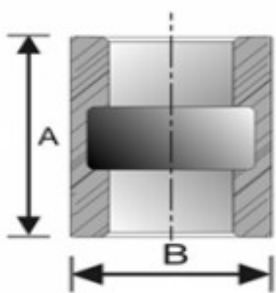

Size	Inner Carton	Master Case	Weight Each lbs.	A Inch	B Inch	304ss Item Code	316ss Item Code
1/8"	200	800	0.0400	0.94	0.59	A3030402	A3230402
1/4"	120	480	0.0700	1.10	0.73	A3030404	A3230404
3/8"	100	400	0.1000	1.14	0.87	A3030406	A3230406
1/2"	60	240	0.1400	1.34	1.04	A3030408	A3230408
3/4"	36	144	0.2000	1.34	1.26	A3030412	A3230412
1"	18	72	0.3300	1.69	1.54	A3030416	A3230416
1-1/4"	12	48	0.5300	1.89	1.93	A3030420	A3230420
1-1/2"	12	48	0.6000	1.89	2.17	A3030424	A3230424
2"	4	16	0.9800	2.20	2.68	A3030432	A3230432
2-1/2"		10	2.1300	2.56	3.39	A3030440	A3230440
3"		6	2.6000	2.80	3.94	A3030448	A3230448
4"		4	4.0900	3.27	4.96	A3030464	A3230464